

Memory Module Specifications

KSM26RS4/16HAI

16GB 1Rx4 2G x 72-Bit PC4-2666

CL19 Registered w/Parity 288-Pin DIMM

DESCRIPTION

Kingston's KSM26RS4/16HAI is a 2G x 72-bit (16GB) DDR4-2666 CL19 SDRAM (Synchronous DRAM) registered w/ parity, 1Rx4, ECC, memory module, based on eighteen 2G x 4-bit FBGA components. The SPD is programmed to JEDEC standard latency DDR4-2666 timing of 19-19-19 at 1.2V. Each 288-pin DIMM uses gold contact fingers. The electrical and mechanical specifications are as follows:

FEATURES

- Power Supply: VDD=1.2V
- VDDQ = 1.2V
- VPP - 2.5V
- VDDSPD=2.25V to 2.75V
- Functionality and operations comply with the DDR4 SDRAM datasheet
- 16 internal banks
- Bank Grouping is applied, and CAS to CAS latency (tCCD_L, tCCD_S) for the banks in the same or different bank group accesses are available
- Data transfer rates: PC4-2666, PC4-2400, PC4-2133, PC4-1866, PC4-1600
- Bi-Directional Differential Data Strobe
- 8 bit pre-fetch
- Burst Length (BL) switch on-the-fly BL8 or BC4(Burst Chop)
- Supports ECC error correction and detection
- On-Die Termination (ODT)
- Temperature sensor with integrated SPD
- This product is in compliance with the RoHS directive.
- Per DRAM Addressability is supported
- Internal Vref DQ level generation is available
- Write CRC is supported at all speed grades
- CA parity (Command/Address Parity) mode is supported

SPECIFICATIONS

CL(IDD)	19 cycles
Row Cycle Time (tRCmin)	45.75ns(min.)
Refresh to Active/Refresh Command Time (tRFCmin)	350ns(min.)
Row Active Time (tRASmin)	32ns(min.)
Maximum Operating Power	*
UL Rating	94 V - 0
Operating Temperature	0° C to +85° C
Storage Temperature	-55° C to +100° C

* See IDD Table (page 2)

Module Assembly

DRAM: HYNIX (A-DIE)

RCD: IDT

Continued >>

IDD Specifications

IDD		unit
Symbol	2666	
IDD0	1219	mA
IDD0A	1219	mA
IDD1	1425	mA
IDD1A	1461	mA
IDD2N	1021	mA
IDD2NA	1021	mA
IDD2NT	1129	mA
IDD2NL	841	mA
IDD2NG	1021	mA
IDD2ND	1021	mA
IDD2NP	1021	mA
IDD2P	655	mA
IDD2Q	931	mA
IDD3N	1345	mA
IDD3NA	1345	mA
IDD3P	997	mA
IDD4R	2739	mA
IDD4RA	2955	mA
IDD4RB	2919	mA
IDD4W	2631	mA
IDD4WA	2631	mA
IDD4WB	2523	mA
IDD4WC	2487	mA
IDD4WP	2901	mA
IDD5B	4045	mA
IDD5F2	3091	mA
IDD5F4	2821	mA
IDD6N	418	mA
IDD6E	526	mA
IDD6R	274	mA
IDD6A	526	mA
IDD7	4935	mA
IDD8	238	mA

IPP		unit
Symbol	2666	
IPP0	108	mA
IPP1	126	mA
IPP2N	58	mA
IPP2P	58	mA
IPP3N	270	mA
IPP3P	270	mA
IPP4R	270	mA
IPP4W	270	mA
IPP5B	1170	mA
IPP5F2	846	mA
IPP5F4	720	mA
IPP6N	72	mA
IPP6E	126	mA
IPP6R	74	mA
IPP6A	126	mA
IPP7	522	mA
IPP8	58	mA

MODULE DIMENSIONS

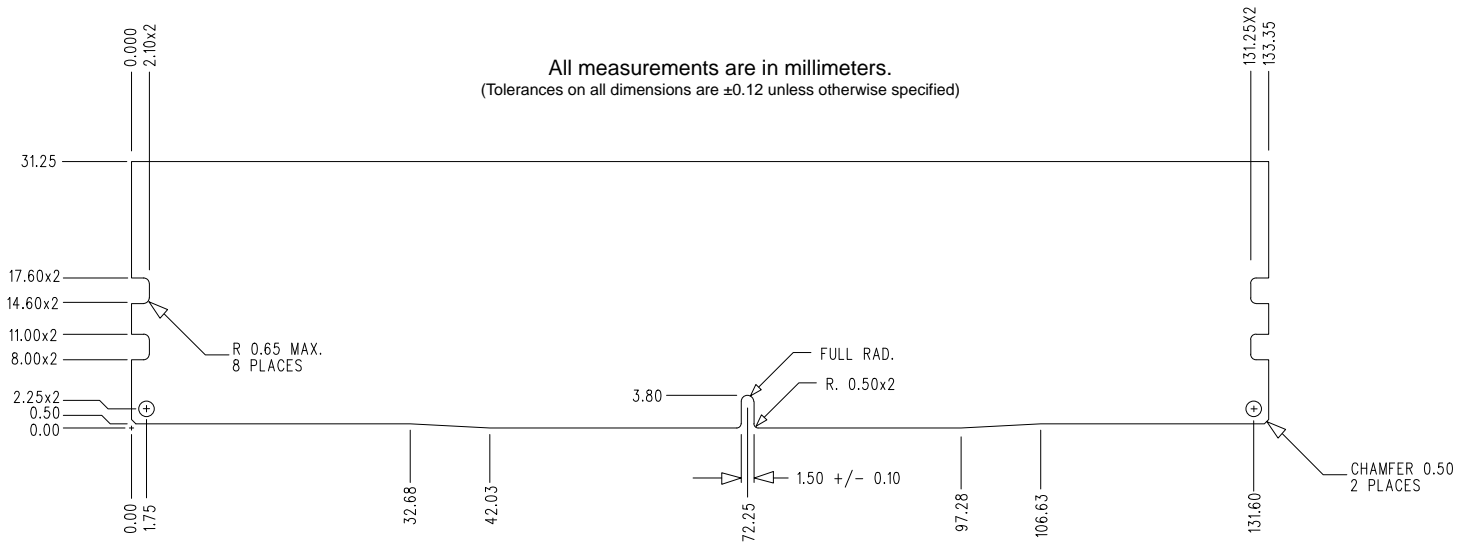
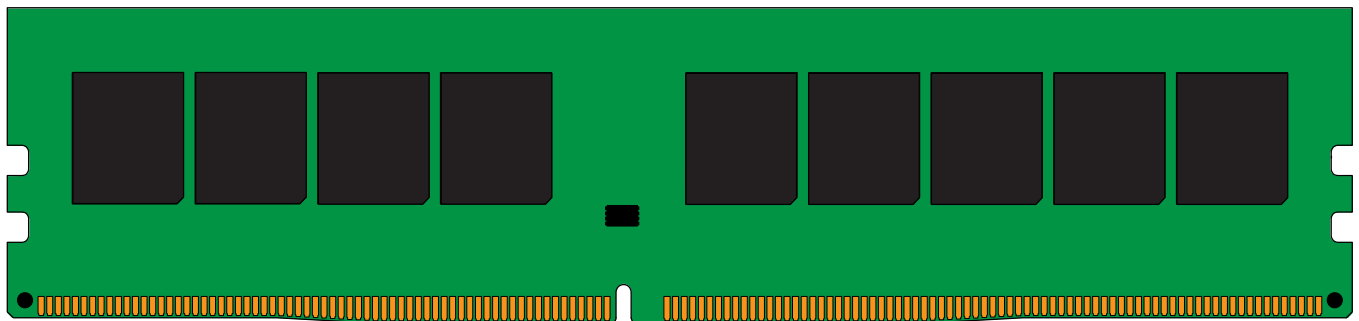
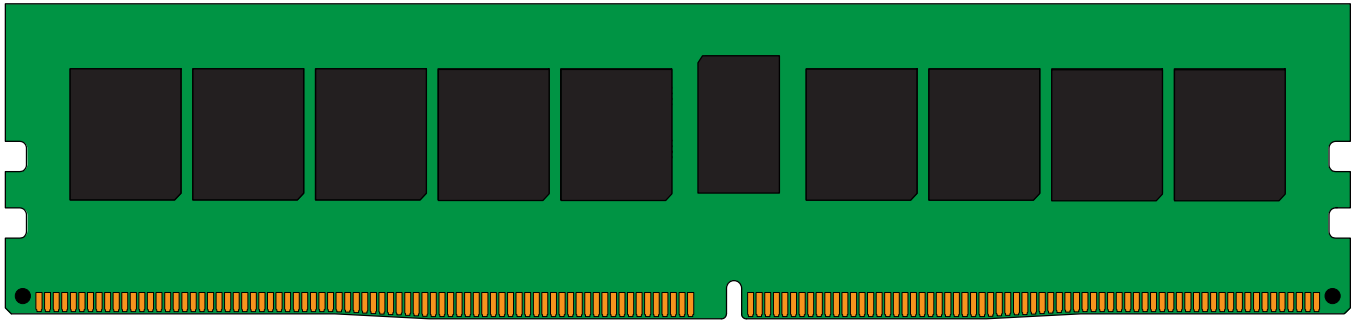

The product images shown are for illustration purposes only and may not be an exact representation of the product. Kingston reserves the right to change any information at anytime without notice.